

THE VALLEY AND EAST COAST VOICE

Vol. 1²² No. 21 P.O. Box 100 St Marys. Friday 10th March 1978. Price 10c.
Reg. at the G.P.O. Hobart for transmission through the post as a periodical

EDITORIAL.

It is not to be denied that modern society has made giant strides of discovery. But it is equally clear that it has mainly failed to apply the new knowledge for the benefit of mankind. The failure is so pronounced that it is dragging Western Civilisation nearer and nearer to some fall like Lucifer's. Perhaps it can be summed up as the loss of a design of living. To be destroying the earth birds, beasts, fishes, vegetation, and most of all soil in order to make money out of it, and for nearly every country in the world to be fighting either within itself, or with other countries, does not make sense. To be producing goods to perish at once in war and in mere quantity with no customers or no money to buy does not make sense. Commonsense is the corner stone of a design for living. But it is only the corner stone, nor can the design be restored by abandoning the new knowledge and returning to the past. We cannot put the leaves back on the trees in winter. What we can do is to find once more the living truth that crowned it with leaves and fruit. Of that living truth the organic way of growth out of the fundamental realities is the beginning. On the material side, a self supporting and organic agriculture is essential because there is now no other way of feeding the peoples of the world with food enough. By food I mean food from which the vital properties have not been removed nor sacrificed by modern ingenuity in evading organic laws for profits sake. There is no other way of maintaining the fertility of the soil that is to say of passing on human life from age to age. There is no other way of building up resistance to deficiency diseases in man, beast, plant and soil. To support ourselves by organic methods would lead us out of the economic wilderness by opening up vast new fields

of employment in the home market by making use of local materials now wasted, and by diverting trade finance to national needs with which neither of them has for many years had anything to do, and organic self help cannot exist without the just price. But the spiritual side is just as real and urgent, and the just price our practical need was once a religious precept. The organic way of life is also a means of developing character, independence, ownership, whether co-operative or individual and a right relation with nature. These are implicitly spiritual needs and an indispensable part of a design for living. If fulfilled they would correct the mechanical bias of the age. Mechanisation of the land has in fact been adopted to fit into a modern economics based upon a purely quantitative production, but it defeats its own ends. "Combine farming is unquestionably wasteful both in grain and straw, it is using up fertility because the chemical bag is the only fertilizer to replace the drain on the organic plant food, it is expediency farming. But we cannot help it. Nearly all our labour has been taken from us, our live stock has been depleted by bad policy and good husbandry has been at a discount.

St. Helens
ANTIQUES

and gifts

37 Quail Street - St. Helens

Antiques and Old World
Furniture.

China, Glassware and Jewellery
BOUGHT AND SOLD.

PH. 761499

AH.761378.

CLASSIFIEDS CONTINUED:

TO GIVE AWAY....TWO PURE BRED RED SETTER
PUPS. Barb Critchlow, Beaumaris..

FOR SALE....One Lounge Suite. good order
\$150.00. Motor Bike 350 Honda. - Goes
well. \$250.00. Bruce Miller, Fingal.

WOOD.....WOOD.....WOOD.....WOOD
ORDER YOURS NOW PHONE 725165

ALLAN JACKSON IS YOUR MEDIBANK AGENT.
LET HIM HELP YOU WITH YOUR CLAIMS!!!
Feeling kind of Run down & tired of cutting
wood? Give yourself a treat, install a gas
heater before the winter & enjoy that cosy
instant heat. For a free quote contact
your local registered gas plumber:-
L/S Targett St.Marys Phone 72 2344

WANTED TO SELL.....1968 Mazda Deluxe 4
door sedan. Excellent condition, radio
& heater, 5 new tyres, 12 months registrat-
ion. \$1850. Contact Miss Trudy Johnson,
Fingal 742196.

FOR SALE....ANTIQUES: Quality period
furniture, china, glassware and jewellery
etc., at reasonable prices. ST. HELENS
ANTIQUES, 37 Quail Street, St. Helens,
Phone 76 1499 or A.H. 76 1378.

BURNS BRICKS.....ST. HELENS
For looks and economy you can't beat the
look of real bricks when renovating an
old or shabby house. We will be pleased to
quote you. Also available very cheap are
brick pieces suitable for edging your
gardens and paths. Enquiries to phone
76 1462 or Box 87, St. Helens, P.O.

cont. page 3

ST HELENS PH: 76 1119
A.H. 76 1330
Ceelia St.
St. Helens

HARDWARE

COMPLETE RANGE OF NEW HANDTOOLS
BUILDERS SUPPLIES, PAINT, GIFTWARE
AND KITCHENWARE

Hrs: Mon.- Fri. 8.30am - 530 pm
Sat. 9.00am - 12 noon

NEW & SECONDHAND CARAVANS NOW
AVAILABLE FOR SALE INSPECTION
WELCOME.

CLASSIFIEDS

FOR SALE

16ft Millard Capri Caravan 4 or 6
berth, Carpet throughout.
Good condition. Apply Ruth Saunders Fingal
\$2500.00 o.n.o.

FOR SALE

2 Houses and Land
Apply Mrs I Targett c/o M. Britton.

FOR SALE

1972 FordCortina Deluxe model
4 on the floor. \$2100. Contact John Davern
St.Marys Phone 722356.

WANTED TO SELL: 1968 MAZDA DELUXE 4 DOOR
SEDAN. Excellent condition, radio & heater,
5 new tyres, 12 months Registration. \$1,850
Contact: Miss Trudy Johnson,
Fingal. Phone 74 2196

FOR SALE

RAYBURN COMBUSSTION STOVE
with hot water cylinder & supply tank
good order Phone 76 1471 after 6 p.m.

For Sale

1975 TS 185 SUZUKI TRAIL BIKE
with new motocross tyre (extra).
Black magic paintwork
\$550. o.n.o. Phone 76 1471 after 6 p.m.

FOR SALE ST. MARYS

13 acres land, 6 head of cattle
3 in calf, permanent water, very large build-
ing cement floors and walls, incorporating
Hardware Store, plus stock, 9 roomed house
cement brick, floor coverings, deep free ze
and frige, Convair,septic tank, town water
supply, 6 car garage, \$50,000 plus stock
o.n.o. Phone 72 2272.

RICHARDS HOME
FURNISHERS

ST.HELENS

PHONE 76 1147

WE SPECIALIZE IN QUALITY

CARPETS

FREE MEASURE AND QUOTE
MANY ARTICLE REDUCED OVER NEXT
TWO WEEKS.

CALL AND SEE US
Now:

QUAIL STREET ST. HELENS

ijs

NEW SEASONS

SLACKS, PINAFORES, SKIRTS, JUMPERS

T. SHIRTS, DRESSES

VARIETY OF SUMMER STOCK TO GO AT REDUCED PRICES

PIFFLE

CONGRATULATIONS

To Val Schier on her marriage to Keith Wilson of Perth W. Aus, they have settled in Perth, so we wont see Val for a while in Falmouth.

Also congratulations to David Schier in Hobart, he has his Laws Degree, also is rowing in the Kings Cup crew, this is being held on the Franklin River on Easter Saturday, and for the first time ever held in Tassy.

Mrs Ryan of Queensland is spending several weeks with her brother Mr Eric Eberhard of Mangana.

CLASSIFIEDS CONTINUED

REDLINE BUS SERVICE delivers this paper quickly and efficiently. Why not let them work for you???

KING'S BUS SERVICE.....St. Marys, St. Helens, Bicheno, Swansea. Phone Winnaleah 54 2251.

QUIK-BRIK VENEER

YOUR WEATHER-BOARD OR FIBRO HOME

ELIMINATES PAINTING - CONDENSATION

FREE QUOTE:

R. RUSHTON
SCAMANDER
C/- P.O.

PHONE: 72 5122



Sole Tasmanian Distributors of



SALES REPRESENTATIVE for St. Helens Fingal Valley and surrounding Districts is:

PETER BUGG

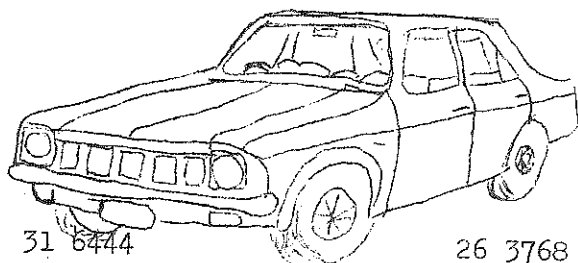

31 6444

26 3768

WHATS ON

LADIES FELLOWSHIP

This Monday Night at 7-30pm sharp. We will be having a PROGRESSIVE SUPPER. All ladies to meet at Mrs Karlene Richards home to arrange rides etc. The cost for the supper will be 60¢. We welcome all ladies to attend. Lucky door prize at each home we call at.

TASMANIAN PENSIONERS UNION

A meeting of the Fingal-St Marys Branch will be held in the Institute St Marys on Tuesday 14th March at 2pm. Business - Election of Officers. All Pensioners are invited to attend. John Spilsbury Hon Treasurer.

BOYS ACTIVITY GROUP

A meeting will be held at the kindergarten St Marys on Monday 13th March at 7-30 pm to discuss the possibility of forming a Boys Activity group for boys between 6 and 10 years. All parents who have boys in this age group are invited to attend. Mrs Cheryl Hendley has offered to hold activity group meetings weekly based on activities used by Cubs and Scouting groups.

OPENING WEDNESDAY 15th MARCH

Mens Hairstylist in Todds Hall St Marys Geoff Baldock will be specialising in all mens hairstyles. Wed-9-6 Thur 9-6 Fri 9-9.

ADULT EDUCATION CLASSES will start soon

Painting with Leo Cook in the Art Room Mondays 7pm. 13th March
Woodwork with Mr Denney in the woodwork room Wednesdays 7-30pm 15 March.

HOSPITAL AUXILIARY FAIR....Friday March 17th. Good well-stocked stalls.

ANNUAL MEETING.....Ladies Committee St. Maras Football Club. 7.30pm at Clubrooms Thursday 16th March.

D.K.&C.M. BARNES ST MARYS

WILL DELIVER WREATHS

FRESH & ARTIFICIAL FLOWERS

BRIDAL BOUQUETS

PHONE: 72 2267
A.H. 72 2265

church & news

CATHOLIC PARISH OF ST. MARYS

MASS TIMES

11th & 12th March

St. Helens Sat. Vigil 6.30pm
St. Marys Sun. 9.00am
Fingal Sun. 10.30am

18th & 19th March

Sat. 18th Feast of St. Joseph
Mass at St. Joseph's Fingal 12 noon
St. Helens Sat. Vigil 6.30pm
St. Marys Sun. 9.00am
Mangana Sun. 10.30am

Holy Week & Easter

Holy Thursday (25th) St. Marys 7.30pm
Good Friday St. Helens 10.30am
St. Marys 3.00pm

Holy Saturday Vigil

St. Marys 7.30pm
East Sunday Fingal 8.00am
St. Helens 10.30am & 12 noon
Bicheno 6.00pm

Confessions before Easter:

St. Helens Thurs. 23rd 5.30-6.00pm
Good Fri. 10.00am
St. Marys Good Fri. 2.30pm
Holy Sat. 11.30am to noon

NEST SUNDAY.....A cordial invitation extended to all to be present at the Ceremony of Blessing of the new statue of the Mother of Jesus by Rt. Rev. Mgr. B.C. Rogers, V.G. at 5.00pm. Followed by evening Devotions & Benediction, and Tea in the Memorial Hall. Unless weather is poor, congregation assembles in front of the church at 5pm.

ST. MARYS DISTRICT SCHOOL PARENTS & FRIENDS ASSOCIATION

ANNUAL MEETING

21st March, 1978

AT DISTRICT HIGH SCHOOL

Election of Office Bearers
Financial Report

To be followed by a General Meeting
K.M. Crowden, Sec.

CHURCH OF ENGLAND PARISH OF ST. HELENS

Sunday March 12

8.00am H.C. St. Helens
11.00am M.P. St. Helens

Sunday March 19

8.00am H.C. St. Helens
11.00am M.P. St. Helens
11.00am H.C. Pyongana

Thursday March 23

7.30pm H.C. St. Helens

UNITING CHURCH FINGAL-PORTLAND PARISH

Sunday March 12

St Marys 11am Vincent
St Helens 7.30pm Vincent
Fingal 9.30am Vincent

Sunday March 19

St Marys 11am Bible Society
St Helens 7.30pm Vincent
Fingal 9.30am Bible Society

THE CHURCH OF ENGLAND FINGAL AVOCA CULLENSWOOD PARISH

Sunday 12 March

9.00am Fingal M.P. Rector
11.00am Avoca M.P. Rector
3.00pm Mangana H.C. Rector
7.00pm St. Marys E.P. Rector

Sunday 19 March

9.00am Fingal H.C. Rector
10.30am St. Marys H.C. Rector
7.00pm Avoca H.C. Rector

Services for Good Friday

8.00am Avoca
9.30am Fingal
11.00am Cullenswood

Services for Easter Day

8.00am Avoca
9.30am Fingal
11.00am Cullenswood

VALLEY FASHION WEAR

74 2214

Main Road, FINGAL

SALE!!! SALE!!! SALE!!!

SKINNY RIB JUMPERS

15% OFF DAYWEAR

10% OFF NIGHTWEAR

SALE!! SALE!! SALE!!

W. LOCKETT & SONS FUNERAL DIRECTORS CAMPBELL TOWN

Enquiries may be directed through
D.E. Casboults, St. Marys
72 2143

or

T. Pears, Campbelltown 81 1167
Bruce Davidson, Funeral Director

SPORTS

ST. MARYS GOLF CLUB

Associates		Stableford
C White	(21)	43 pts
J Cornelius	(26)	39 pts
R Gill	(24)	37 pts
E Herring	(26)	37 pts

Miss White reduced	24 - 23
Mrs Cornelius "	30 - 29
Mrs Gill "	27 - 26

Flag

Mrs Herring	19th Green
Mrs C Barnes	19th Green
Mrs C White	18th Green
Mrs P Davern	18th Green

E Herring reduced from	28 - 26
C Barnes " from	35 - 31
C White " from	23 - 22

MEMBERS

STABLEFORD

A Grade	K Leedham	43 pts
---------	-----------	--------

B Grade

R Spillsbury	17	41 pts
--------------	----	--------

By Ten Up

St. Marys Bowls Club

The St. Marys Bowling club has conducted its annual Club Championships for 1977/1978.

Winners Mens singles. C Berwick
Ladies Singles Ivy Brennan
Mens pairs F Singline
and B Lehner for the 3rd time.

Ladies pairs W Tapp and F Freeman.

The East Coast Championships will be played at St Helens. March 11th.
Singles Club represented will be Swansea, Bicheno, St Marys, & St Helens.
The Pairs Championships, will be played at Bicheno on March 18th.

Mrs Brennan has won the Singles & Handicap Championships also the 100 up. competition.

LIONS BINGO

\$ 75.00 JACKPOT

TUESDAY 7.30pm

LOG FIRES

Supper provided R.S.L. Institute

MEALS ON WHEELS ROSTER

MARCH

Sunday
Monday
Tuesday
Wednesday
Thursday
Sunday
Monday
Tuesday
Wednesday
Thursday

PINGAL

R. Saunders
R. Marshall
Father Jarrett
Mrs. G. Miller
B. Saunders
D. Williams
Sharon Hall
A.S. McKenzie
L. Parker
R. McGee

MANGANA

M. Francis
J. H all
J. Miller
Mrs. Sweeney
A.S. McKenzie
R. McGee

ST. MARYS

Greg Tapp
Yvonne Salter
Margaret Bullock
Jill Faulkner
Geoff Gill
Bob Cook
Mary King
Mary Targett
Jim Napier
Joan Smith

L.C."CACTUS" FREEMAN

A FIRST FOR ST. MARYS

24 HOURS CARTAGE
SERVICE

WOOD GRAVEL & GENERAL
CARTAGE

#

TRENDSETTA

#

ST. MARYS

PHONE 72 2372

BEAUT RANGE OF
LADIES

ROSSY

LIPP

&

RIKKI

JUMPERS

New range of
childrens BELLA jumpers

FORESTRY ACTIVITIES

Mr Andrew Lohrey M.H.A. made this information available about the Forestry areas in Fingal and Portland Municipalities.

The Forestry Commission is currently building roads in the T.P.F.H. Concession to enable logging to commence in East Mt Foster and North of St Marys to Upper Scamander with an estimated expenditure for 1997/78 of \$200,00. The planned cut of chipwood for delivery to Fingal railhead from the Crown is 82,700 tonnes to 1979/80 and then 75,200 tonnes due to the decrease in plantation establishment. Fully integrated operations at Koses Tier commenced in 1972 and the planned cut is 49,000 tonnes which is carted by road via Company and Commission roads to the Tasman Highway. Due to low soil fertility it has been found necessary to aerial fertilise. Current programme is 960 ha, at an estimated expenditure of \$79,000. On steeper slopes the plantations are being non-commercially thinned at ages 7 to 9 years depending on the site quality of the stand. Current annual expenditure is \$ 1,205,000 providing for an employment of 63 staff at the Fingal office is 13.

comprises 76,600 ha, (48% of the area of the Municipality) and Crown Land 14,300 ha, (9%). St Helens Timber co Pty Ltd have cutting rights in the higher quality forests in the Urana and Goulds Country areas with a maximum allocation of 13,200 m. The sawmilling complex is one of the main industries of St Helens, and comprising a sawmill, chipper, kilns and planting mill. Sawm timber is carted from Swansea by road for further processing at the plant. Three operations have sleeper quotas totalling 26,000 sleepers per annum. On present planning fully integrated cutting by T.P.F.H. Ltd is likely to commence in 1981/82. Roads constructed by the commission is both Native Forests and Plantations total 287 km. Current expenditure is \$120,000 providing employment for 5 men living in the Municipality. A Forest Officer is located at St Helens Employment at sawmills and associated bush operations is 56. Planting commenced at Tower Hill in 1962, followed by Nicholas 1963, Saddleback 1965. Evercreech and Mt Ygung 1975. Goulds country 1965 and Scamander 1965.

* * * * *

The Portland Municipality State Forests

ST MARY'S
BAKERY

of
JIM &
DIANNE SPRIGGS

FOR
PIES PASTIES BREAD

PASTRIES CAKES AND

BUNS

HARVEY WALLACE
— WILLIAMS

OPTOMETRIST
OPTICIAN CONTACT LENS PRACTITIONER
ST HELENS

"Last Friday in every month"

RING: Kelvin Viney Pharmacy 761374

BP SERVICE STATION

B&J.A. SPILSBURY

AGENTS FOR: VICTA MOWERS
CHAIN SAWS

SEE BRUCE FOR THE GOOD JUICE!!

DF&MD. MATTHEWS

ST. HELENS PHONE 76 1438

FOR ALL

HOME FURNISHINGS

ELECTRICAL APPLIANCES SCREENS &
BLINDS

FINGAL VALLEY WELFARE COMMITTEE FOR SENIOR CITIZENS

The above Committee met with the Minister for Housing, Mr. G. Chisholm, on the occasion of the Cabinet Meeting with the Municipal Council, when Mr. Chisholm kindly arranged to discuss future housing units for the Fingal Valley area. He announced six units (depending on Government finance) for St. Marys in 1978/79, 3 Fingal 1979/80 and three each 1980/81. The Committee expressed concern at the delay for Fingal, but Mr. Chisholm said that the Department had arranged the building programme according to need. However, he agreed to send one of his officers to interview any prospective applicants on receipt of information from the Committee. Any people desirous of applying for Home Units (single or double) should apply to the Domiciliary Sister (Sister J. Refshaw) or the Secretary of the Fingal Valley Welfare Committee, Mr. J. Miller, C/- Forestry Commission, Fingal, for information.

THE FINGAL VALLEY COMMUNITY YOUTH SUPPORT SCHEME

The Community Youth Support scheme has now opened an office to serve the Fingal Valley. Our aims are to help in every way the needs of the unemployed in the district. For the scheme to work effectively we need to be approached by both the unemployed and employers of the Fingal Valley as well as individuals and organis-

ations interested in community development. For further information please contact the C.Y.S.S. Office at the Fingal Council Chambers.

FINGAL VALLEY WELFARE COMMITTEE FOR SENIOR CITIZENS

Date: 13th March
Venue: Institute, St. Marys
Time: 7.30pm
Chairman: Warden of Fingal, Mr. A. Freeman
Guest Speaker: Rev. Mgr. Bernard Rogers (who will also sing)
Supper: Ladies a plate
Reports: Annual Report by Chairman Mr. J. Napier
 Club reports from Golden Years Club, Silver Threads Club, Sunshine Welcome Club, Meals on Wheels Association.
Election: Of incoming Committee.

This is a Public meeting and all are welcome.
 Display of Slides by Mr. Tim McManus
 Mr. J. Miller.

RETURN
 THANKS

MANY THANKS to all the kind friends and relations who sent me cards and flowers "deeply appreciate", during my stay in the Launceston General Hospital.

Maisie Pilgrim

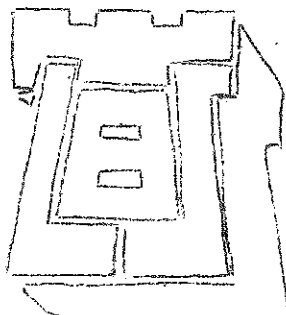

INSURANCE SERVICES

OUR NEW SERVICE PROVIDES:

PROTECTION FOR YOU, YOUR HOME AND THE MEMBERS OF YOUR FAMILY RESIDING WITH YOU.

Covering

- Your home and contents
- Your family's liability to the public
- Your personal valuables
- Your wearing apparel
- Your liability as employer to domestic employees
- Your mortgage repayments in the event of your death.

All these and more can be -
 arranged locally
 paid for locally
 claimed against locally
 at your branch of the L.B.S.

ST HELENS BAKERY

Phone 76 1162

SMALLGOODS CAKES PASTRIES

WEDDING & BIRTHDAY

CAKES ICED

Bus orders taken

FINGAL VALLEY PUMPING SERVICE

wish to announce they are at your service for any pumping problems:-

SEPTIC TANKS

INDUSTRIAL WASTES

DRAINS ETC.

72 5165

72 5211

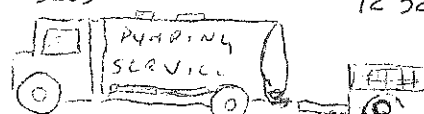

GARDEN CLUB NOTES

St Marys Garden Club held its first meeting for 1978 on Feb 23rd. Ten members were present. Mrs Marg Aulich chaired the meeting. Roll Call was the most exciting thing that has happened since the last meeting.

Birthday posys were received by L Rattray, M Oliver, Floral Art Arrangements L Rattray, M Royle, L Rattray, Novice Marj Aulich L Mitchell, 2nd and 3rd.

Any vegetable. L Rattray, E Hughes, M Oliver Raspberry Jam. A Jarvis, E Llewellyn, Linda Rattray.

Next meeting will be held march 30th.

Prize donors, for march Lucky door, Linda Mitchell.

Raffle. E Hughes

Competition Molly Aulich,

Vegetable of the month, Red Beet.

Home Producer Boiled Fruit Cake.

Special Competitions Dried Bush arrangements

Rosy Hosts for three months M Royle.

It was in the Paper

WANTED A steady young woman to wash, iron, and milk two cows.

Q. How can you tell the age of a snake?

A. It is extremely difficult to tell the age of a snake unless you know exactly when it was born.

FASHION PARADE

An Autumn winter Fashion Parade is to be held at the community hall on Fri April 7th at 7.30 pm. in aid of St. Marys Kindergarten.

A raffle at 20 cents per ticket for a \$15.00 voucher from "Trendsetta" will be drawn during the evening.

Supper and Refreshments served.

Tickets: \$2.50.

Phone: 61 600.

Adults and Childrens fashions will be modelled.

REMEMBER
RED CROSS
ON SUNDAY
APRIL 2ND

LETTER TO THE EDITOR

After the events which took place on our property last Sunday (March 5th), We find we once again publish that, Trespasses on any of our property will be prosecuted and dealt with according to the law. We regret having to do this but those people who knocked down the Walnuts and broke off the limbs and branches of this Beautiful old tree must understand that a stop must be put to this kind of thieving and destruction.

It would be more manly to come and ask and not to hide in the scrub when they hear us approaching.

Signed

H. J & B. J. AULICH.

ST. MARYS.

OPEN INVITATION

FLO & JIM HARRIS of Scamander

HARLEY & SYD RAINBOW of Ansons Bay

INVITE ALL RESIDENTS

IN THE ST. HELENS AREA AND SURROUNDING DISTRICTS TO A FREE DEMONSTRATION OF: QUALITY, HOME, PERSONAL & CAR CARE PRODUCTS

Come along and see how you can save dollars on your weekly budget.

Time: 7.30pm Date: April 14th

Place: C/-E Hall, St. Helens.

LEAVE YOUR MONEY AT HOME

ALSO SEEN IN THE PAPER

By an typographical error we were made to say last week that the retiring Mr. was a member of the defective branch of the police force. Of course this should have read: The detective branch of the police force.

ADULT DENTAL = CARE =

Dr. M McCarthy will be providing adult dental care.

Every third Saturday beginning on April 8th. For appointment phone 72 2266

Between 9am - 10 am.

Weekdays.



HELP THE RABBIT

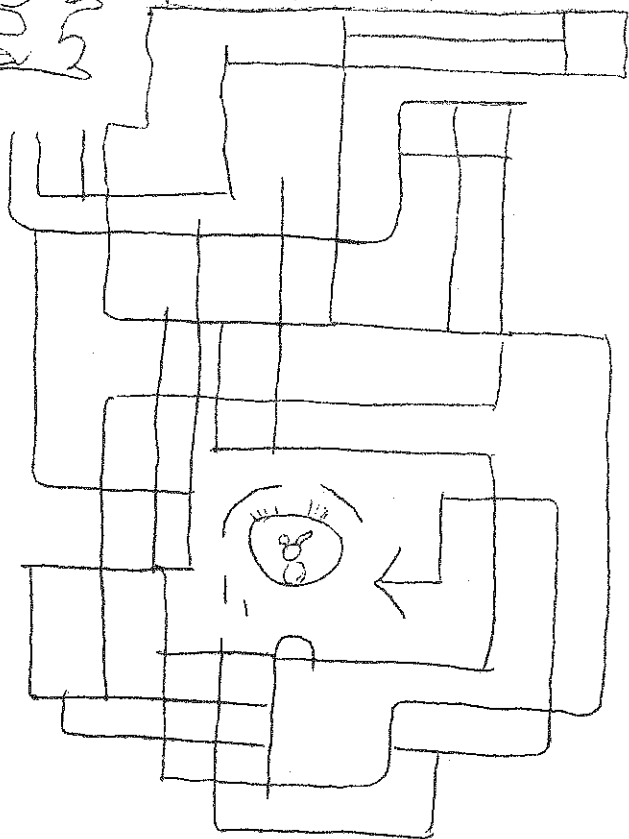

CAN YOU FIT THE RIGHT WORDS IN
THE RIGHT PLACES IN THESE WELL
KNOWN EXPRESSIONS ?

- 1 Like a ____ in a china shop.
- 2 To run with the ____ and hunt with the hounds.
- 3 The ____ is mightier than the sword.
- 4 Put your ____ to the grindstone.
- 5 Turn over a new ____.
- 6 ____ of all trades.

SIX RIDDLES

- 1 Why dowhite sheep eat more than black?
- 2 Why cant a steam engine sit down?
- 3 Why is the letter E lazy?
- 4 Do you need training to be a litter collector?
- 5 What does a ball do when it stops rolling?

- 6 Why is it bad to write on an empty stomach?

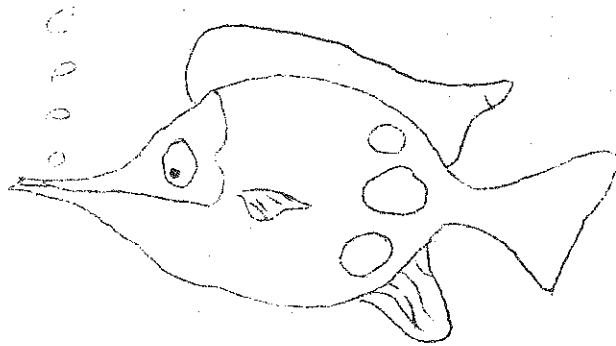

ALL THESE THINGS BEGIN WITH
THE LETTER G. CAN YOU NAME THEM?

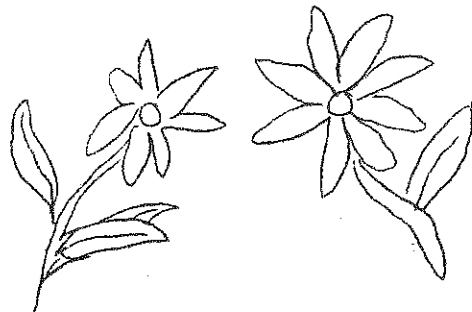

ANSWERS

1 Bull. 2 Hare. 3 Pen. 4 Nose. 5 Leaf. 6 Jack.

1 Because there are more of them. 2 Because it has a tender behind. 3 Because it is

always in bed. 4 No, you pick it up as you go along. 5 It looks round. 6 Its not so bad,

really, but paper is better.

STARDUST

By Mercurj

Fortnight from March 10

ARIES: Mar. 21 - Apr. 20

Keep alert for possibilities outside your usual work, excellent judgment and quick decisions may be needed since the trends are of short durations. Lucky days 12, 15.

TAURUS: Apr. 21 - May 20

This period can bring greater stability into your domestic life, you may find calmness and security in relationships, health is good. Lucky days 17, 19.

GEMINI: May 21 - June 21

Don't give way to self pity or let things get the better of you, you may travel quite a long way, an unexpected event may put you in line for progress. Lucky days 15, 17.

CANCER: June 22 - July 22

Some big plans may be in the making, trouble with health may keep you from carrying them out, have work done on teeth and you will feel better. Lucky days 15, 19.

LEO: July 23 - Aug. 22

Avoid fussing about trivialities, travel is favoured just now, use your skills and your personality on the job, but don't criticize others. Lucky days 20, 22.

VIRGO: Aug. 23 - Sept. 23

Do not deceive anyone, spend wisely, follow an outline already made about important life areas, family matters concern you, perhaps more than they should, you may get a letter about a surprise. Lucky days 16, 18.

LIBRA: Sept. 24 - Oct. 23

Don't set yourself up to take an elected position in your group if you are not prepared to follow through with time, energy, efforts and assets. Lucky days 14, 19.

SCORPIO: Oct. 24 - Nov. 22

Be ready to cope with new problems in joint finances. Give these matters careful thought, discuss any changes with your partners, a relative may need help, give it. Lucky days 17, 22.

SAGITTARIES: Nov. 23 - Dec. 21

Some of the best aspects are in joint enterprise matters also in creative and artistic ventures, but don't have too many irons in the fire. Lucky days 13, 18.

CAPRICORN: Dec. 22 - Jan. 20

Planning is favoured just now, so take future possibilities into your plans, don't let promises allure you, take good care of health. Lucky days 18, 20.

AQUARIUS: Jan. 21 - Feb. 19

Concentrate your best efforts on career matters, get moving on something important in your personal life, the time is harmonious. Lucky days 13, 16.

PISCES: Feb. 20 - Mar. 20

Good outlook for working with your talents, keep up the creative trend, avoid showing hostility to an old friend of the family. Lucky days 19, 21.

ST MARYS BUTCHERY

We don't keep the best -

WE SELL IT!!!

Phone 72 2274

THE CARLYLE

"SUMMER SALE"

Tops \$6. T Shirts \$3.50.

Slacks - All Reduced.

Frocks, Slack-Suits, Men's Ties

All reduced.

Mr. Stretch Slacks - \$12.00